

Soils Map

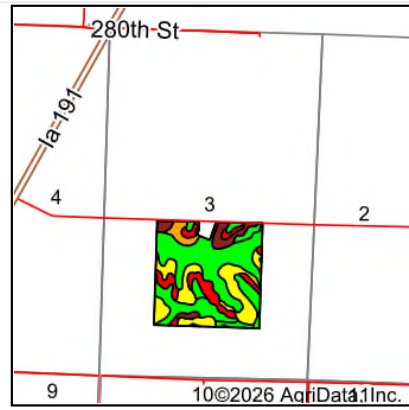

State: **Iowa**
 County: **Harrison**
 Location: **3-78N-41W**
 Township: **Washington**
 Acres: **155.64**
 Date: **1/12/2026**

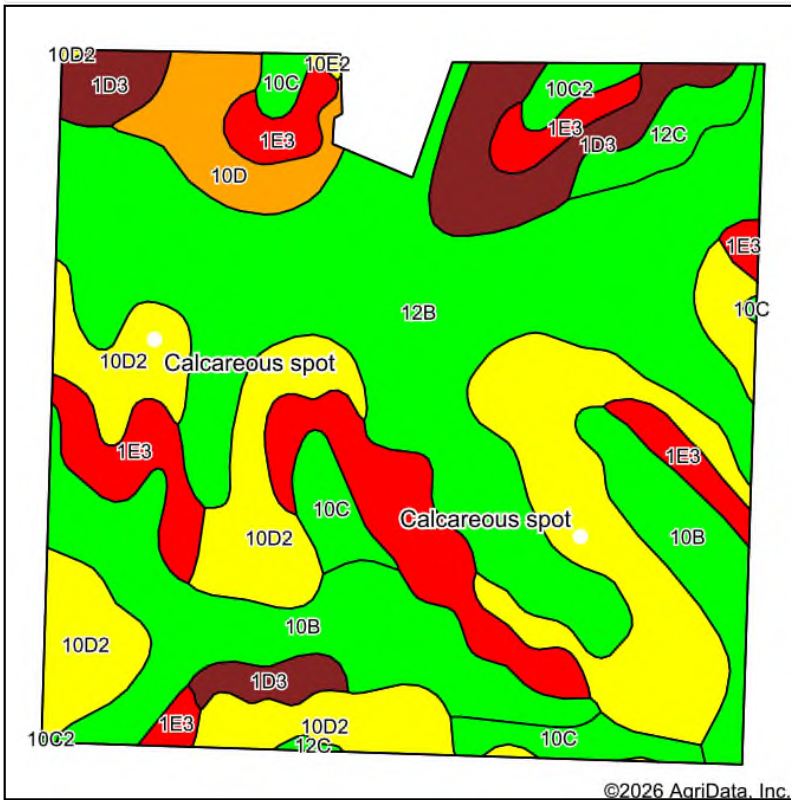

Maps Provided By:



Soils data provided by USDA and NRCS.

©2026 AgriData, Inc.

© AgriData, Inc. 2025

www.AgriDataInc.com

Area Symbol: IA085, Soil Area Version: 34

Code	Soil Description	Acres	Percent of field	CSR2 Legend	Non-Irr Class *c	Irr Class *c	Range Production (lbs/acre/yr)	CSR2**	Alfalfa hay Tons	Caucasian bluestem Tons	Common bermudagrass Tons	Orchardgrass red clover Tons	Tall fescue Tons	Warm season grasses Tons	*n NCCPI Overall
12B	Napier silt loam, 2 to 5 percent slopes	50.32	32.3%	■	Ile		0	93							89
10D2	Monona silt loam, 9 to 14 percent slopes, eroded	37.67	24.2%	■	IIle		0	60							76
10B	Monona silt loam, 2 to 5 percent slopes	22.42	14.4%	■	Ile	IIIe	4000	95	7	8	7	7	7	8	88
1E3	Ida silt loam, 14 to 20 percent slopes, severely eroded	18.63	12.0%	■	IVe		0	18							57
1D3	Ida silt loam, 9 to 14 percent slopes, severely eroded	10.56	6.8%	■	IIle		0	32							60

Soils data provided by USDA and NRCS.



Code	Soil Description	Acres	Percent of field	CSR2 Legend	Non-Irr Class *c	Irr Class *c	Range Production (lbs/acre/yr)	CSR2**	Alfalfa hay Tons	Caucasian bluestem Tons	Common bermudagrass Tons	Orchardgrass red clover Tons	Tall fescue Tons	Warm season grasses Tons	*n NCCPI Overall
10C	Monona silt loam, 5 to 9 percent slopes	5.77	3.7%		IIIe		0	89							87
10D	Monona silt loam, 9 to 14 percent slopes	5.59	3.6%		IIIe		0	63							83
12C	Napier silt loam, 5 to 9 percent slopes	3.10	2.0%		IIIe		0	89							87
10C2	Monona silt loam, 5 to 9 percent slopes, eroded	1.40	0.9%		IIIe		0	86							81
10E2	Monona silt loam, 14 to 20 percent slopes, eroded	0.18	0.1%		IVe		0	45							71
Weighted Average					2.65	*-	576.2	70.8	1	1.2	1	1	1	1.2	*n 79.5

**IA has updated the CSR values for each county to CSR2.

*n: The aggregation method is "Weighted Average using all components"

*c: Using Capabilities Class Dominant Condition Aggregation Method

*- Irr Class weighted average cannot be calculated on the current soils data due to missing data.

Symbol	Name	Description
CAC	Calcareous spot	An area of soil containing enough calcium carbonate to effervesce strongly when treated with cold dilute hydrochloric acid. Typically .25 to 2 acres.